

## Bunford Park, Western Relief Road

Yeovil, BA20 2HT

**Strategic Development Site  
in Yeovil with plots available  
via Freehold sale or  
Leasehold with Design &  
Build opportunities.**

**1.20 to 43.10 Acres**

(0.49 to 17.44 Hectares)

- B1 (Office) & Industrial Planning Consent
- Available in Separate Lots
- Freehold Land Sales
- Freehold Design & Build
- Leasehold Design & Build

# Bunford Park, Western Relief Road, Yeovil, BA20 2HT

## Summary

<b>Available Size</b>	1.20 to 43.10 Acres
<b>EPC Rating</b>	Upon enquiry

## Description

The site, outlined red on the plan opposite, is greenfield with extensive frontage to the A3088 Western Relief Road in an area of established and expanding residential, employment and alternative use.

DEVELOPMENT LAND - FOR SALE FREEHOLD / LEASEHOLD DESIGN & BUILD OPPORTUNITIES (9 mins) (11 mins) 27 miles 28 miles 39 miles 41 miles 48 miles (37 mins) (47 mins) (1 hr 15 mins) (1hr 26 mins) (1 hr 14 mins) The total site area measures 16.5 ha (41.25 acres) and is accessed directly from the A3088.

The site is within 10 minutes of Yeovil town centre and 7 minutes of the A303.

Following grant of outline planning consent, initial infrastructure works have been undertaken to construct the access from the A3088.

## Location

Yeovil is the principal town in South Somerset with a population of c.50,000. It has an established and diverse employment, retail and leisure base and an expanding population.

Yeovil is located at the intersection of the A37 and A303 national trunk roads and is served by two mainline railway stations. The site is also located on a national freight route between the A303 and the South coast with total vehicle traffic movements per day over 20,000 (2022 DFT statistics).

Local occupiers include Leonardo Helicopters, Screwfix, Wickes, Bradford & Sons, Honeywell Aerospace and Yodel.



## Viewing & Further Information

### Alex Halle

07442 241844

alex.halle@htc.uk.com

### Andrew Batchelor

0117 946 4510

andrew.batchelor@htc.uk.com

### Simon Harvey

01179 464 520 | 07785 222 868

simon.harvey@htc.uk.com

### William Shortall

0117 946 4519 | 0777401 7218

william.shortall@htc.uk.com



**BUNFORD  
PARK** YEOVIL

**DEVELOPMENT LAND - FOR SALE  
FREEHOLD / LEASEHOLD DESIGN & BUILD OPPORTUNITIES**

BA20 2HT



Abbey Manor Group



WICKES



GARADOR



SOMERSET  
COUNCIL



HOWARDS  
PEUGEOT



TOOLSTATION



HONEYWELL  
AEROSPACE



YODEL



SCREWFIX



LEONARDO  
HELICOPTERS

## SITE HIGHLIGHTS

- ⇒ 43.10 acres (17.24 ha) of high profile strategic development land fronting onto the busy A3088.
- ⇒ Allocated employment site with the benefit of an implemented outline planning permission.
- ⇒ Attractive business environment in an edge of town location in close proximity to established employment, residential and alternative land uses.
- ⇒ Available in separate plots, to suit individual occupier requirements.
- ⇒ Available on either a freehold or leasehold design and build basis. Alternatively plot sales on a freehold basis will be considered.



## LOCATION

Yeovil is the principal town in South Somerset with a population of c.50,000. It has an established and diverse employment, retail and leisure base and an expanding population. Yeovil is located at the intersection of the A37 and A303 national trunk roads and is served by two mainline railway stations.

The site is also located on a national freight route between the A303 and the South coast with total vehicle traffic movements per day over 20,000 (2022 DfT statistics). Local occupiers include Leonardo Helicopters, Screwfix, Wickes, Bradford & Sons, Honeywell Aerospace and Yodel.

### Travel Timings

Yeovil Town Centre	2.2 miles	(9 mins)
Train Station	2.9 miles	(11 mins)
M5 – Taunton	27 miles	(37 mins)
Weymouth	28 miles	(47 mins)
Bath	39 miles	(1 hr 15 mins)
Bristol	41 miles	(1hr 26 mins)
Exeter	48 miles	(1 hr 14 mins)

Source: Google Maps

## DESCRIPTION

The site, outlined red on the plan opposite, is greenfield with extensive frontage to the A3088 Western Relief Road in an area of established and expanding residential, employment and alternative use.

The total site area measures 16.5 ha (41.25 acres) and is accessed directly from the A3088. The site is within 10 minutes of Yeovil town centre and 7 minutes of the A303.

Following grant of outline planning consent, initial infrastructure works have been undertaken to construct the access from the A3088.

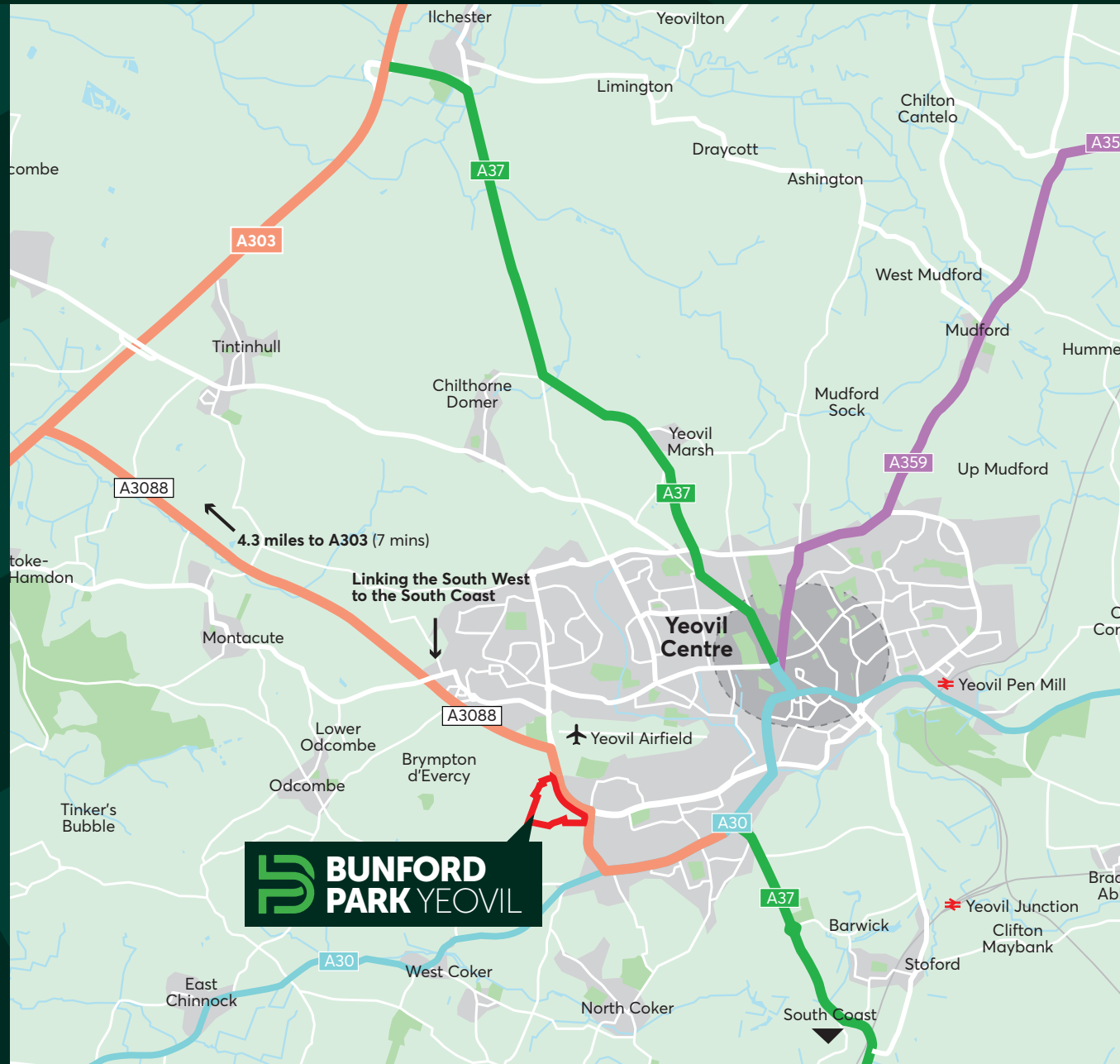

## PLANNING CONSENT

The entire site benefits from planning consents now implemented (07/05341/OUT, 19/03000/S73), B1 Office and Industrial use buildings and a current reserved matters application.

Initial infrastructure works have been completed (hatched in blue on the plan opposite).

## THE DEVELOPMENT OPPORTUNITY

The site is allocated for employment uses under the South Somerset Local Development Plan (2006-2028) and alternative uses would be considered subject to planning.

The site is 17.24 ha (43.1 acres) and plots will be made available to meet occupiers specific land and building requirements from 0.2 ha (0.5 acres)

The land is owned freehold by Abbey Manor Group and will be sold or developed for freehold or leasehold Design Build opportunities to meet specific occupier requirements.

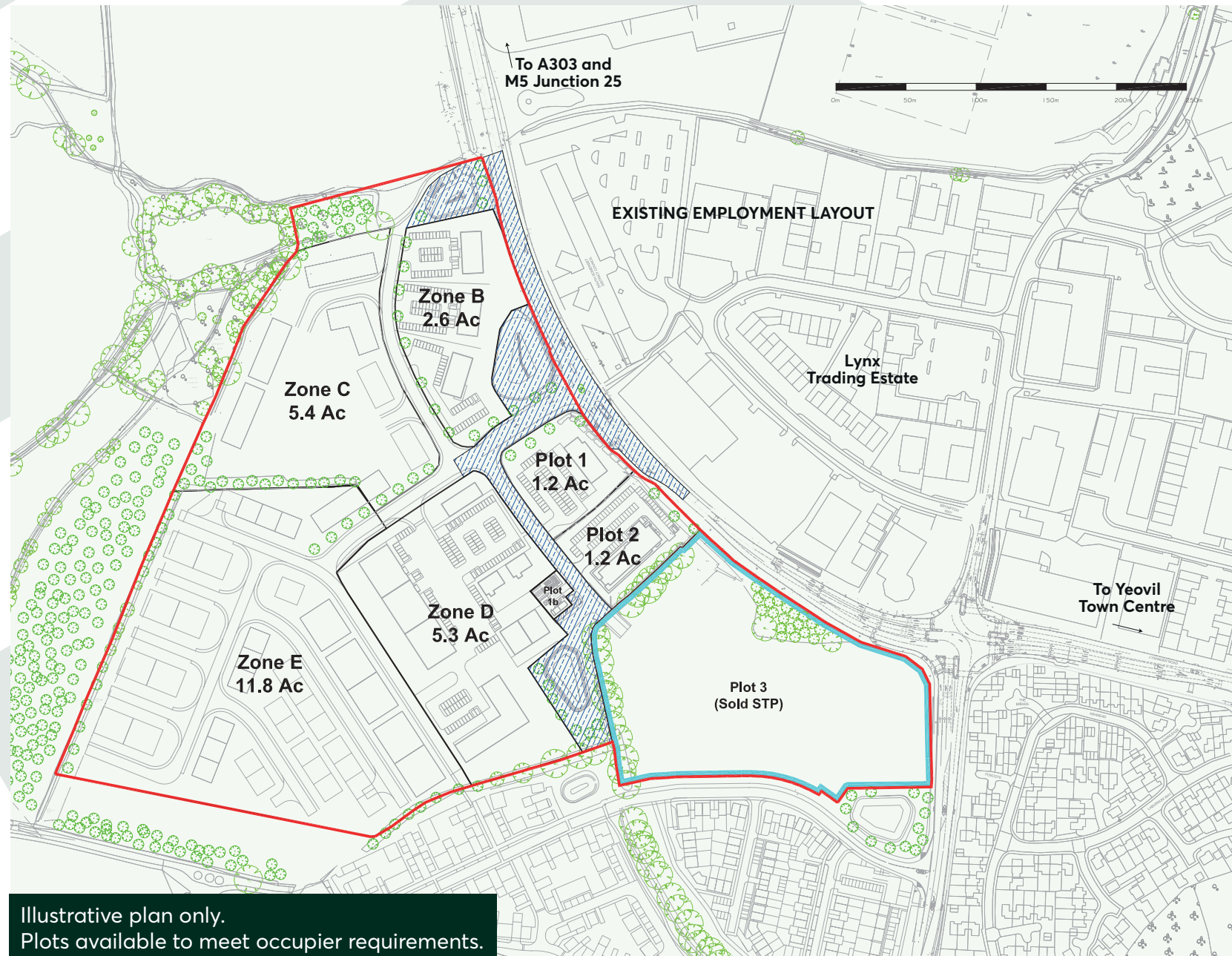

Illustrative plan only.  
Plots available to meet occupier requirements.

## LEGAL & PROFESSIONAL COSTS

Each party is to bear their own costs incurred in this transaction.

## VAT

Proposals should be expressed exclusive of VAT which will be charged.

Please follow the below link to access the dedicated scheme website:

[bunfordpark.co.uk](https://www.bunfordpark.co.uk)

## VIEWINGS & ENQUIRIES

To arrange a viewing and discuss terms, please contact the joint agents JLL and Hartnell Taylor Cook:



### EMPLOYMENT USES

Chris Yates  
**DD:** 0117 946 4520  
**M:** 07785 222 868  
**E:** [chris.yates@jll.com](mailto:chris.yates@jll.com)

Tim Western  
**DD:** 0117 946 4519  
**M:** 07774 017 218  
**E:** [tim.western@jll.com](mailto:tim.western@jll.com)



### EMPLOYMENT USES

Alex Halle  
**DD:** 0117 923 9234  
**M:** 07442 241 844  
**E:** [alex.halle@htc.uk.com](mailto:alex.halle@htc.uk.com)



### ALTERNATIVE USES

Andrew Batchelor  
**DD:** 0117 946 4510  
**M:** 07836 744 015  
**E:** [andrew.batchelor@htc.uk.com](mailto:andrew.batchelor@htc.uk.com)

### SUBJECT TO CONTRACT

Date of Production – September 2024

HartnellTaylor Cook LLP and JLL for themselves and for the vendor or lessor of this property, whose agent they are, give notice that: • These particulars are set out as a general outline only for the guidance of intending purchasers or lessees and do not constitute part or whole of an offer or contract; • All descriptions, dimensions, photographs, references to condition and necessary permissions for use and occupation and other details are given in good faith and are believed to be correct, but intending purchasers or lessees should not rely on them as statements or representations of fact and must satisfy themselves as to their correctness; • No person in the employment of HartnellTaylor Cook LLP and JLL has any authority to make or give any representation or warranty whatsoever in relation to this property or these particulars nor enter into any contract on behalf of the vendor or lessor; • Unless otherwise stated, all prices, rents and other charges are quoted exclusive of VAT. Any intending purchasers or lessees must satisfy themselves independently as to the incidence of VAT in respect of any transaction; • All plant, machinery, equipment, services and fixtures and fittings referred to in these particulars were present at the date of publication. They have not been tested and we give no warranty as to their condition or operation; • No responsibility can be accepted for any expenses incurred by the intending purchasers or lessees in inspecting properties that have been sold or withdrawn; • Unless expressly stated any intended purchasers or lessees must satisfy themselves independently as to the instance or otherwise of any noxious substance.